

## Campbell house, Graceville

Address 37 Molonga Terrace, Graceville, Brisbane, Q

Practice Donald Watson

Designed 1987 Completed 1988

History & Description The Robin Boyd award winner in 1989, this carefully considered riverfront home draws on various inspirations for its complex form. The client requested a 'Walter Taylor' inspired house to replace an existing dwelling in a mature garden. What they received was a crafted 3 level building overlooking a pool and the river with a terracotta tiled roof and stained weather board walls. It was skilfully inserted into the site to respond to aspect, trees and views. The house is entered down an easement and only visible from the river. A modern Arts and Crafts approach, it demonstrated a climatic response with refinement and grace. Each room has outdoor areas and makes use of skylights to filter natural light deep within the space. A boathouse and garden structures complete the landscaping.

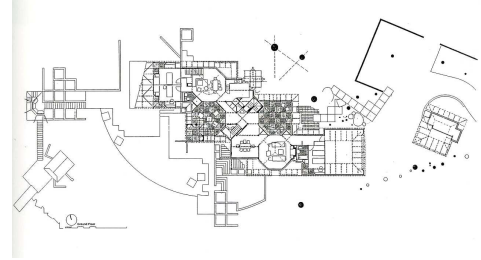

Images: Award Winning Australian Architecture; photos R Stringer.

Statement of Significance Watson has completed many public projects – TAFE colleges and the like - but houses are comparatively rare. This house has a completeness and budget which makes it remarkable.

Criteria Applicable N1 – Significant heritage value in demonstrating principal characteristics of a particular class or period of design.

N2 – Significant heritage value in exhibiting particular aesthetic characteristics.

